

Cable throttle blipper Model ZC160-1, ZC159-1

Introduction:

When running paddleshift gear change systems it is necessary to blip the engine on down changes to ensure a smooth and efficient change. For engines with traditional cable throttles a pneumatically operated mechanical blipper is required.

The Shiftec cable blipper is designed to provide a powerful and reliable actuation of the throttle cable.

It is designed so the cable passes through the blipper which then acts on the outer sleeve. This allows flexibility when mounting the blipper as it does not need to be engine mounted.

CNC machined from aluminium billet and protectively anodised, the blipper has two mounting holes for secure installation.



Summary:

- Direct action on throttle cable
- Can be mounted away from engine
- Compact design
- Powerful action
- 10 or 15mm stroke depending on type
- JIC standard air fitting
- Two M6 clearance mounting holes
- Proven durability

System requirements:

| | | |
|-----------------------------|-------|----------------|
| Air supply | | <10 bar |
| Ambient working temperature | | -10 to +70 °C |
| Installation notes | | See Appendix 1 |

Technical data:

| | | | |
|----------------------------|-------|----------|----------|
| Maximum operating pressure | | 10 | bar |
| Stroke | | 10 or 15 | mm |
| Fitting air in | | Dash 4 | JIC male |

Dimensions:

| | | | |
|--------|-------|----|----|
| Length | | 76 | mm |
| Width | | 27 | mm |
| Height | | 37 | mm |
| Weight | | 90 | g |

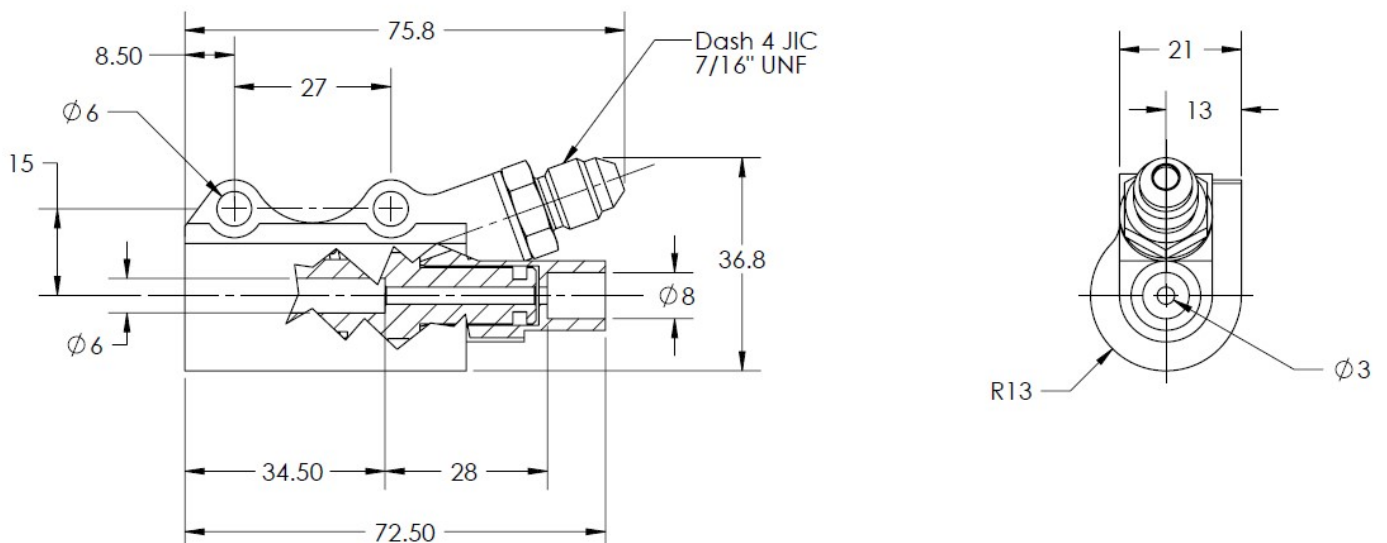
Ordering information:

| Description | Part number |
|---------------------------|-------------|
| Cable blipper 10mm stroke | ZC160-1 |
| Cable blipper 15mm stroke | ZC159-1 |

Appendix 1
Installation notes

- The cable outer sleeve is cut at the point where the blipper is to be mounted and the inner cable is passed through the blipper.
- The remaining piece of outer cable is shortened by 28mm and reassembled before the cable is attached to the throttle.

Appendix 2
General notes

- Install away from direct heat sources.
- Use copperslip when attaching hose fittings – not Loctite or PTFE tape.
- Use only aluminium or stainless steel hose fittings