

Side mount throttle blipper Model ZC153-1

Introduction:

When running paddleshift gear change systems it is necessary to blip the engine on down changes to ensure a smooth and efficient change. For engines with traditional cable throttles a pneumatically operated mechanical blipper is required.

The Shiftec sidemount blipper is designed to provide a powerful and reliable actuation of throttle linkages. CNC machined from aluminium billet and protectively anodised, the blipper has two mounting holes for secure installation.

The stroke is fixed but there is an adjustable end nudger to allow fine tuning of the amount of engine blip.



Summary:

- Compact design
- Powerful action
- 10mm stroke
- Adjustable, hard wearing end nudger
- Two M6 clearance mounting holes
- Proven durability in 24hr races

System requirements:

Air supply	<10 bar
Ambient working temperature	-10 to +70 °C
Installation notes	See Appendix 1

Technical data:

Maximum operating pressure	10 bar
Stroke	10 mm
Fitting air in	Dash 4 JIC male

Dimensions:

Length	107 mm
Width	50 mm
Height	26 mm
Weight	105 g

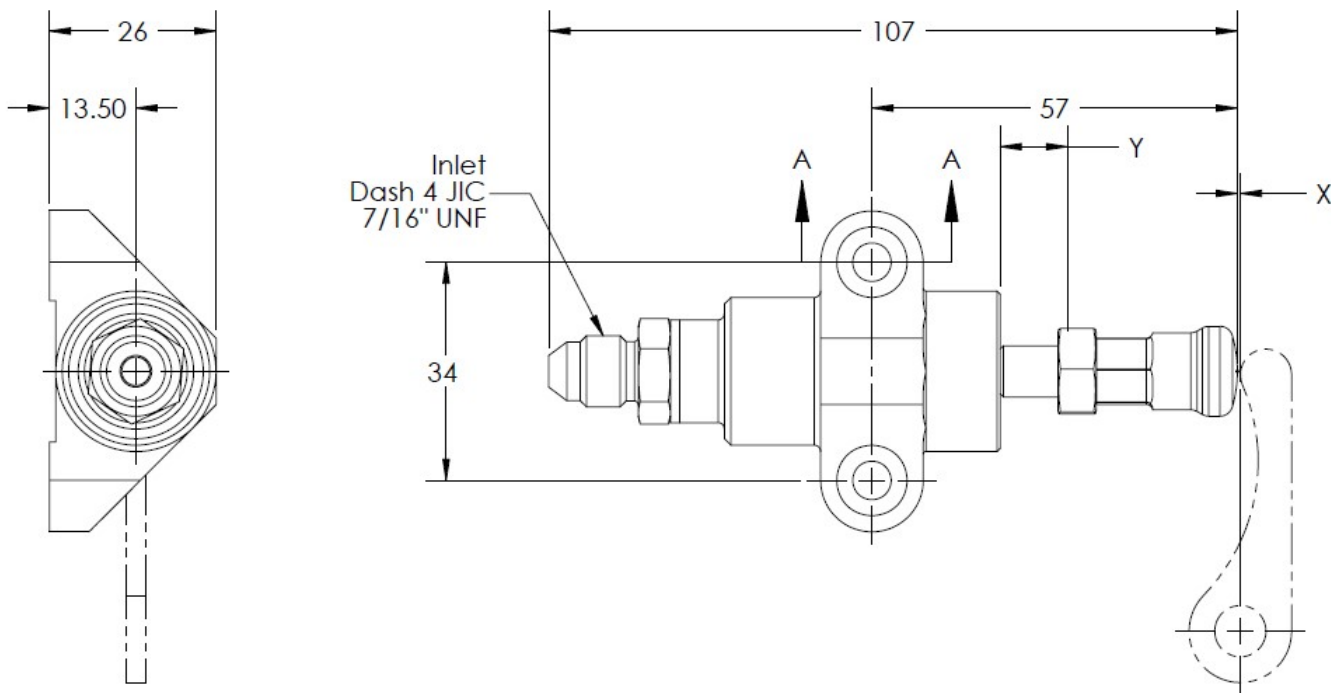

Ordering information:

Description	Part number
Blipper Pro side mount	ZC153-1

Appendix 1 Installation notes

- Install away from direct heat sources.
- Do not strain or side load pipework and fittings.
- Use copperslip when attaching hose fittings – not Loctite or PTFE tape.
- Use only aluminium or stainless steel hose fittings
- Amount of blip required will depend on engine characteristics. ~25% is a good start point
- Ensure nudger end makes smooth contact with throttle linkage starting at 90°